



# NIU CORPORATION

NIU TOILET  
NIU TRAILER



## 2025 MODELS AND INFO

[INFO@NIUTOILET.COM](mailto:INFO@NIUTOILET.COM)  
[WWW.NIUTOILET.COM](http://WWW.NIUTOILET.COM)

1-514-444-3161  
1-855-550-0303

# Niu Toilet Models:



- The T-BOX- single unit washroom
- Washroom Trailers- 6 foot up to 30 foot
- Shower Trailers- 12 foot up to 30 foot
- Laundry Trailers- 16 foot up to 30 foot
- Rehab Trailers- 16 foot up to 30 foot
- Combination Trailers-12 foot up to 30 foot Toilet/Shower/Laundry
- ADA trailers- with all defined ADA accessories- 12 foot up to 30 foot
- Decontamination Trailers- 16 foot up to 30 foot
- Fixed Washroom Structures- 10 feet up to 40 foot
- Prefabricated Washroom structures- 10 feet up to 40 foot
- “Vault” Toilets

## NOTE:

- We offer multiple configurations and options as far as layout and number of stations for each trailer size, and model offered.



[www.niutoilet.com](http://www.niutoilet.com)

### NIU TOILET- KEY ELEMENTS:

- > All units are custom designed as per customers needs/specs and final layout is approved prior to build
- > Units are designed for year-round use
- > Extensive Warranties on all units
- > HVAC and UNLV cleaning and disinfection systems in all units
- > Units can be self-contained and/or directly connected to city services
- > Each unit is designed with cutting-edge technology and are furnished with all standard washroom accessories and features



[www.niutoilet.com](http://www.niutoilet.com)



**NIU TOILET- SAFETY FEATURES:**

- Isolation R26 certified.
- ETL certified.
- CSAA277 Certified
- DOT antibacterial walls certification
- Security IP exterior cameras
- Water efficient certified
- LEED certified.
- EMS package with fire extinguisher
- Fire proof automatic touchless ADA steel doors.
- Energy efficient certified
- Winter package
- Steel interior walls with fire retardant
- Steel exterior walls with fire retardant





www.niutoilet.com



### NIU TOILET- NOTE:

- > The following pages show examples of our different models- and ***within each size and model- we offer various configurations and layouts*** and can design a washroom trailer to suit any, and all requirements.
- > The only difference between each unit size and layout- are the number of stations- Mens/Womens/ADA; number of accessories, and the tank sizes.
- > For all quotes- we simply need to know the number of stations, is ADA/handicap required, and if there are city services available.

# The TBOX- Single Unit- Portable or Fixed Washroom

- NIU T-BOX's solid welded steel insulated structure, provides a compact, modern and practical bathroom perfect for both mobile and permanent applications
- Disinfection of the cabin in a few seconds with UV & ULV-C
- Easy to manipulate with a forklift or a crane. The T-BOX can be transported on a trailer, in a truck or in a sea container due to its compact dimensions (5' x 6' x 9' for a weight of 2300lbs.)
- The bathroom is equipped with a ventilation system and a vent to control odors. During the disinfection of the unit by ULV, a perfume of your choice is diffused.
- Optional Remote Monitoring from any device and from anywhere in the world. Optional indoor 4'x6' screen and outdoor 4'x6' wall mounted screen for information and advertisement.



## INFORMATION DASHBOARD T-BOX

### SOLID STEEL STRUCTURE

Solid welded steel structure, insulated for different climates. Equipped with a basic heating system, it can be optionally equipped with air conditioning.



### WASH YOUR HANDS



Combines an automatic tap and hand dryer so you can wash and dry your hands at the basin, made from high grade, solid Brass. Fitted with an anti bacterial HEPA filter to ensure the air used to dry users hands is as clean and hygienic as possible. Low noise with smart air outlet design - The airflow direction and speed has been carefully configured to ensure that there is no excess splashing or spray created and therefore works with a huge range of sinks.

### TRANSPORT AND HANDLING

Easy to move with a forklift or a crane.



The T-BOX can be transported on a trailer, in a truck or in a sea container due to its compact dimensions 5' x 6' x 9', for a weight of 2300 lbs.



### DISINFECTION OF THE CABIN IN A FEW SECONDS WITH ULV

The disinfectant ULV fogger is a quick and easy way to sanitize spaces. Electrolyzed Water Andlyle Disinfectant 80 to 120 times more effective than bleach cleaners to kill harmful pathogens. Non-hazardous, non-toxic and non-WHMIS regulated. Not harmful to plants, animals, marine life or humans. All-natural antimicrobial solution. Environmentally friendly as it's biodegradable and non-accumulative. The key active ingredient, hypochlorous acid, naturally occurs in molecules synthesized from electrolyzed solutions of salt and water. The electrochemically activated solution is rich in oxygen, where pathogens, bacteria and viruses cannot survive.



### FOOT PEDAL FLUSH



Use your foot to flush the toilet bowl. You don't have to touch with your hands

### ODORLESS BATHROOM

The bathroom is equipped with a ventilation system and a vent to control odors. During the disinfection of the unit by ULV, a perfume of your choice is diffused.

### REMOTE MONITORING INDOOR & OUTDOOR SCREEN



Remote monitoring in option and indoor 4' x 6' screen and outdoor 4' x 6' wall mounted for information and commercials.



### BABY CHANGING SEAT



Wall mounted in option.

### WATER CAPACITY



65 gallon fresh water  
110 gallon waste water

COMAC CORPORATION 576 Bd Industriel, Saint-Eustache, QC, J7R 5V3, Canada T: 1 855 550-0303

# Mobilio 1- 6 Foot - 12 Foot Washroom Trailers

(NOTE: All units- no matter what size- come equipped with all the same product features as listed below)

## INCLUDED PRODUCT Features + Construction:

- Frame made of LINE-X®-treated steel
- Load Levelers 5,000 lb (4).
- Aluminum structure with standard urethane insulated sandwich panel (2" or 3" optional).
- Dexter TorFlex Axle (7500 lbs)
- Good Year Tires ST 205 75R15 or ST 225 75R15
- Electric Brake System
- Step Assemblies with Handrails
- Seamless Aluminum Roof
- 32" Commercial Doors
- Insulated and heated wastewater tank
- FRESHWATER TANK- 300 GALLON
- WASTEWATER TANK- 700 GALLON
- All our units are heated and ventilated.

## STANDARD FEATURES:

- A.C.- 10,000 BTU
- 2 x Ouelette wall heaters
- Water Heater
- Antibacterial walls
- UV disinfection system
- Self disinfection system ULVC
- Self-cleaning HVAC mechanism
- Dual communication system (Remote accessibility)
- GPRS
- Exterior LED occupancy
- Exterior Color- White with Customer logo – if wanted
- Automatic toilets- STAINLESS STEEL OR CERAMIC- CUSTOMER CHOICE
- Touchless Hand dryers / Paper towel dispensers / Toilet paper dispensers
- Automatic Soap dispensers / Automatic faucets
- Sinks- STAINLESS STEEL OR CERAMIC- CUSTOMER CHOICE
- Garbage Bins
- Fire alarm
- Smoke alarm
- Mechanical/Electrical room
- Touchless control panels
- Automatic light (ON & OFF) inside and Motion sensor lights outside- 12V
- 500W/120V Heating system
- Winter package
- Extra keys for all doors



## Mobilio 1- 12 Foot-2 Station Washroom Trailer

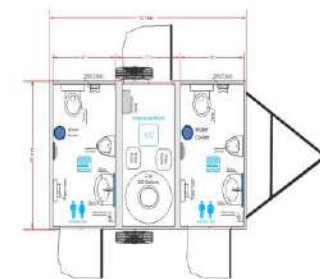
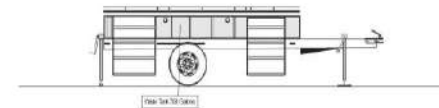
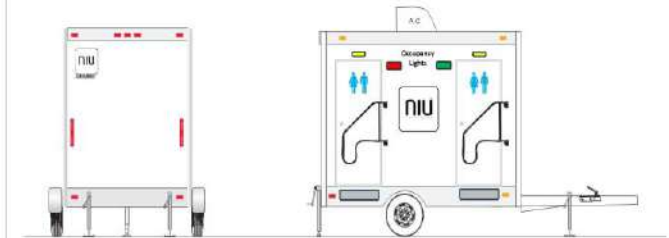

Approved by: \_\_\_\_\_

Signature: \_\_\_\_\_

Date: / /

**niu**  
NORTH  
INDIANA  
UNIVERSITY  
INDIANAPOLIS, IN  
46206-1326  
TEL: 317.497.1234  
WWW.NIU.EDU

# Mobilio 2- 14 Foot - 18 Foot Washroom Trailers

(all units- no matter what size- come equipped with all the product features as listed below)

## INCLUDED PRODUCT Features + Construction:

- Frame made of LINE-X®-treated steel
- Load Levelers 5,000 lb (4).
- Aluminum structure with standard urethane insulated sandwich panel (2" or 3" optional).
- Dexter TorFlex Axle (7500 lbs)
- Good Year Tires ST 205 75R15 or ST 225 75R15
- Electric Brake System
- Step Assemblies with Handrails
- Seamless Aluminum Roof
- 32" Commercial Doors
- Insulated and heated wastewater tank
- FRESHWATER TANK- 300 GALLON
- WASTEWATER TANK- 700 GALLON
- All our units are heated and ventilated.

## STANDARD FEATURES:

- A.C.- 10,000 BTU
- 2 x Ouelette wall heaters
- Water Heater
- Antibacterial walls
- UV disinfection system
- Self disinfection system ULVC
- Self-cleaning HVAC mechanism
- Dual communication system (Remote accessibility)
- GPRS
- Exterior LED occupancy
- Exterior Color- White with Customer logo – if wanted
- Automatic toilets- STAINLESS STEEL OR CERAMIC- CUSTOMER CHOICE
- Touchless Hand dryers / Paper towel dispensers / Toilet paper dispensers
- Automatic Soap dispensers / Automatic faucets
- Sinks- STAINLESS STEEL OR CERAMIC- CUSTOMER CHOICE
- Garbage Bins
- Fire alarm
- Smoke alarm
- Mechanical/Electrical room
- Touchless control panels
- Automatic light (ON & OFF) inside and Motion sensor lights outside- 12V
- 500W/120V Heating system
- Winter package
- Extra keys for all doors



## Mobilio 2- 16 Foot 4 Station Washroom Trailer Mens- 1 Toilet + 1Urinal / Womans- 2 Toilets

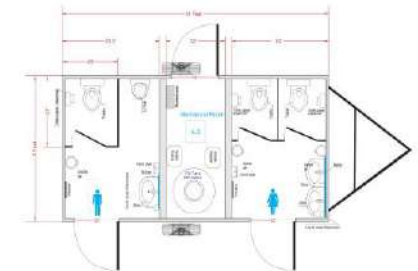
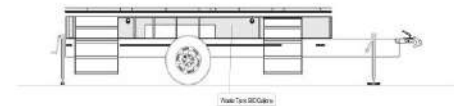
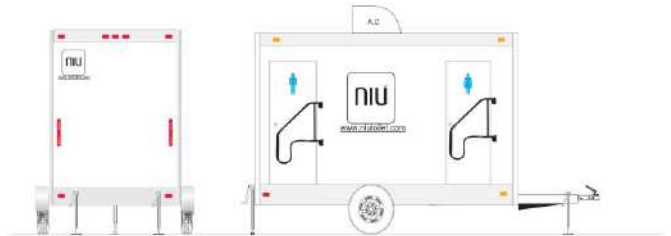

Approved by: \_\_\_\_\_

Signature: \_\_\_\_\_

Date: / /

**NIU**  
NORTH INDIAN  
UNIVERSITY  
2000 N. WINDY HILL  
CAMPUS  
MARIETTA, GA 30067  
770.428.1234  
www.niu.edu

# Mobilio 3- 20 Foot Washroom Trailers

(all units- no matter what size- come equipped with all the product features as listed below)

## INCLUDED PRODUCT Features + Construction:

- Frame made of LINE-X®-treated steel
- Load Levelers 5,000 lb (4).
- Aluminum structure with standard urethane insulated sandwich panel (2" or 3" optional).
- Dexter TorFlex Axle (7500 lbs)
- Good Year Tires ST 205 75R15 or ST 225 75R15
- Electric Brake System
- Step Assemblies with Handrails
- Seamless Aluminum Roof
- 32" Commercial Doors
- Insulated and heated wastewater tank
- FRESHWATER TANK- 300 GALLON
- WASTEWATER TANK- 700 GALLON
- All our units are heated and ventilated.

## STANDARD FEATURES:

- A.C.- 10,000 BTU
- 2 x Ouelette wall heaters
- Water Heater
- Antibacterial walls
- UV disinfection system
- Self disinfection system ULVC
- Self-cleaning HVAC mechanism
- Dual communication system (Remote accessibility)
- GPRS
- Exterior LED occupancy
- Exterior Color- White with Customer logo – if wanted
- Automatic toilets- STAINLESS STEEL OR CERAMIC- CUSTOMER CHOICE
- Touchless Hand dryers / Paper towel dispensers / Toilet paper dispensers
- Automatic Soap dispensers / Automatic faucets
- Sinks- STAINLESS STEEL OR CERAMIC- CUSTOMER CHOICE
- Garbage Bins
- Fire alarm
- Smoke alarm
- Mechanical/Electrical room
- Touchless control panels
- Automatic light (ON & OFF) inside and Motion sensor lights outside- 12V
- 500W/120V Heating system
- Winter package
- Extra keys for all doors



## Mobilio 3- 20 Foot 4 Station Washroom Trailer 4 Private Universal Stations

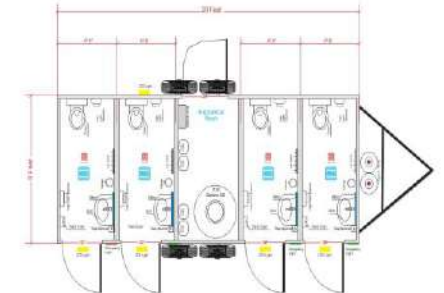
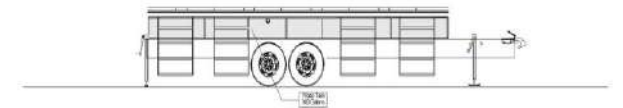
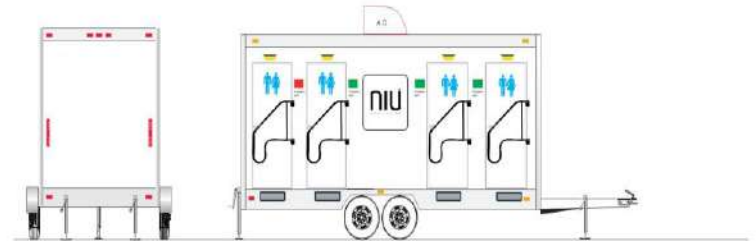

Approved: \_\_\_\_\_

Signature: \_\_\_\_\_

Date: \_\_\_\_\_



# Washroom/Shower Trailers- available in many sizes and layouts

(all units- no matter what size- come equipped with all the product features as listed below)

## INCLUDED PRODUCT Features + Construction:

- Frame made of LINE-X®-treated steel
- Load Levelers 5,000 lb (4).
- Aluminum structure with standard urethane insulated sandwich panel (2" or 3" optional).
- Dexter TorFlex Axle (7500 lbs)
- Good Year Tires ST 205 75R15 or ST 225 75R15
- Electric Brake System
- Step Assemblies with Handrails
- Seamless Aluminum Roof
- 32" Commercial Doors
- Insulated and heated wastewater tank
- FRESHWATER TANK- 300 GALLON
- WASTEWATER TANK- 700 GALLON
- All our units are heated and ventilated.

## STANDARD FEATURES:

- A.C.- 10,000 BTU
- 2 x Ouelette wall heaters
- Water Heater
- Antibacterial walls
- UV disinfection system
- Self disinfection system ULVC
- Self-cleaning HVAC mechanism
- Dual communication system (Remote accessibility)
- GPRS
- Exterior LED occupancy
- Exterior Color- White with Customer logo – if wanted
- Automatic toilets- STAINLESS STEEL OR CERAMIC- CUSTOMER CHOICE
- Touchless Hand dryers / Paper towel dispensers / Toilet paper dispensers
- Automatic Soap dispensers / Automatic faucets
- Shower Stalls with all accessories
- Sinks- STAINLESS STEEL OR CERAMIC- CUSTOMER CHOICE
- Garbage Bins
- Fire alarm
- Smoke alarm
- Mechanical/Electrical room
- Touchless control panels
- Automatic light (ON & OFF) inside and Motion sensor lights outside- 12V
- 500W/120V Heating system
- Winter package
- Extra keys for all doors

## Mobilio 2- 16 Foot 2 Station Washroom / Shower Trailer- 2 Private Universal Stations

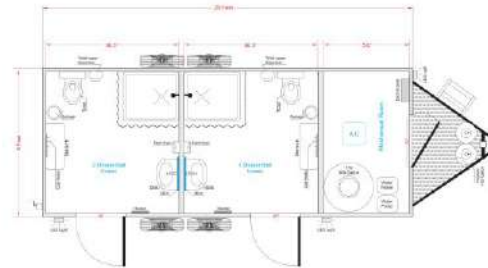
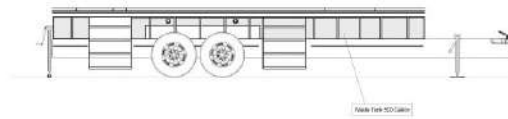
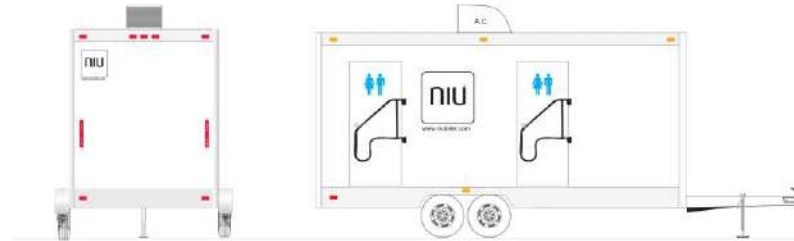

Approved by: \_\_\_\_\_  
Signature: \_\_\_\_\_

Date: / /



## Mobilio 3- 20 Foot 4 Station Washroom / Shower Trailer- 4 Private Universal Stations

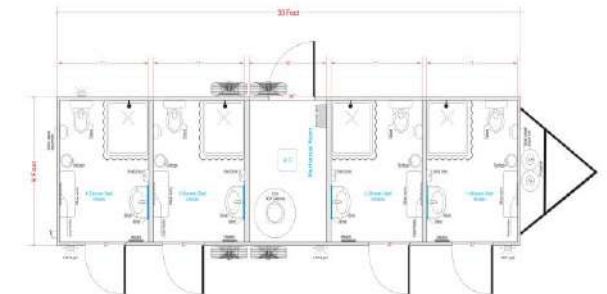
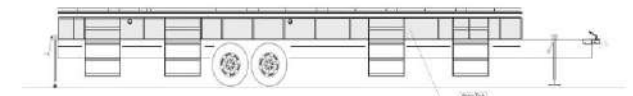
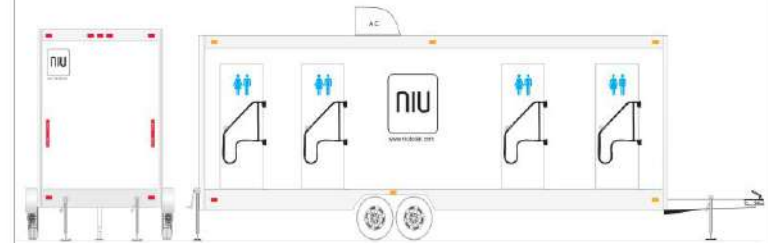

Approved by: \_\_\_\_\_  
Signature: \_\_\_\_\_

Date: / /



# ADA COMPLIANT Washroom/Shower Trailers- available in many sizes and layouts

(all units- no matter what size- come equipped with all the product features as listed below)



## NIU TOILET- ADA / HANDICAP ACCESSIBLE TRAILERS:

- > The following pages show examples of some of our different ADA models- and within each model- we offer various configurations and layouts and can design a trailer to suit any, and all requirements.
- > We offer ADA units in various layouts- Toilet only, Toilet + Shower, etc...and all units have ADA compliant accessories
- > The only difference between each unit size and layout- are the number of stations- Mens / Womens / ADA; and the number of accessories, and the tank sizes.
- > **All our ADA units come with a full dropdown hydraulic chassis for easy set up and access.**

# ADA Trailers- EXAMPLES- available in many sizes and layouts

(all units- no matter what size- come equipped with all the product features as listed below)

## STANDARD FEATURES INCLUDED:

- Fresh Water tank- 300 gallon / Wastewater tank- 700 gallon
- Comac- "ONE" Hand dryers (ADA)
- Touchless Soap dispensers / Touchless Paper towel dispensers
- Baby change stations
- Garbage cans
- Mirrors with LED (Touch feature)
- Stainless steel sinks with counter and vanity
- Waterless Urinal (men's station)
- UV Disinfection
- AC 15000BTU / dual Hot Air heating system / 4 Ouellete Wall heaters (1000w)
- Hydraulic ADA Drop Down Chassis with extendable ramp and automatic Handicap door.
- Touchless door openers (Inside & Outside)
- White Panel finished exterior. / White interior FRP panels
- Night lights / Emergency lights
- Emergency exit button
- Dual connection (Direct connect or generator)
- Magic Mirror with Bluetooth & Defog system
- DOT walls (Antibacterial)
- Exterior LED occupancy custom signage
- Full touchless feature
- Dual connectivity (Self contained / Direct connect)
- Bluetooth speakers in all bathrooms
- Solar Step LED exterior lights with motion sensors
- ULV disinfection system (HVAC)
- Security camera (Dual connection with Night vision and speaker)
- Dual Hydraulic Axle 7500lb each.
- ADA Emergency push button
- 4units, 5500 support drops.
- Battery booster
- Winterized package
- ADA steel ramp with push button
- Customized customer Logo for the exterior
- Black F1 mags and rims
- Remote control for easy hydraulic control
- Keyless entry for the mechanical room
- Water lever indicator (waste water & Fresh water) with live monitoring capability

**BEST SELLER**

## Mobilio 3- 20 Foot 3 Station Washroom Trailer- 1 MENS / 1 WOMENS/ 1 ADA Station

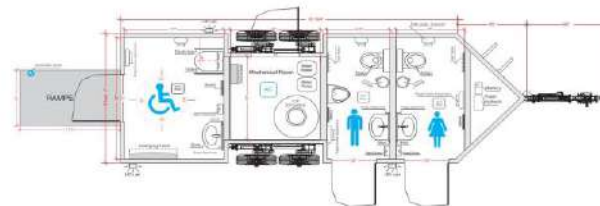
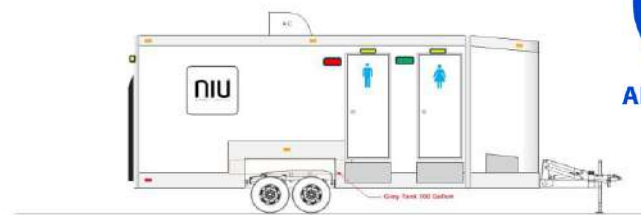
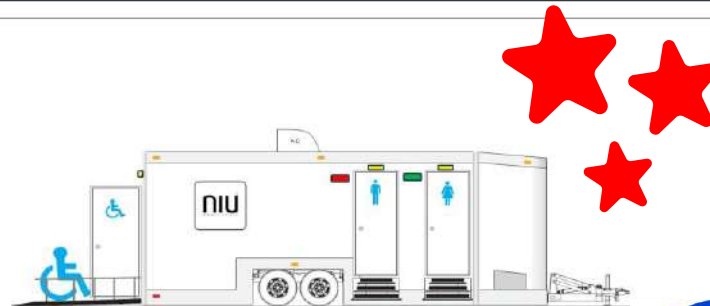

## Mobilio 2- 14 Foot 2 Station Washroom Trailer 1 ADA + 1 Universal Station

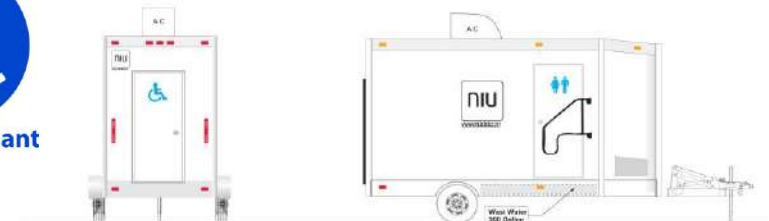
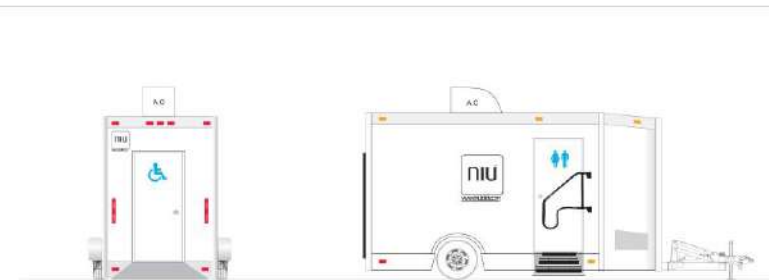

Approved by: \_\_\_\_\_  
Signature: \_\_\_\_\_

NIU  
Date: 7 / 7

Approved by: \_\_\_\_\_  
Signature: \_\_\_\_\_  
Date: 7 / 7

NIU  
Date: 7 / 7

# - ADA TRAILERS - EXAMPLES OF VARIOUS TOILET MODELS



**NIU TOILET- 2025-  
MOBILIO 1- 8 X 12- ADA TOILET**

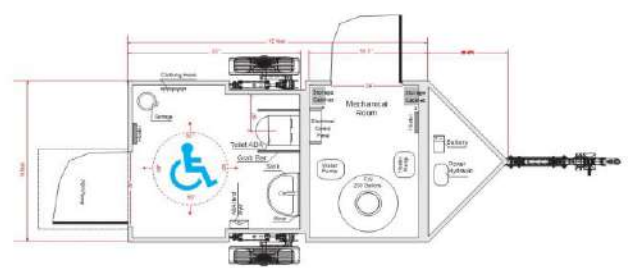
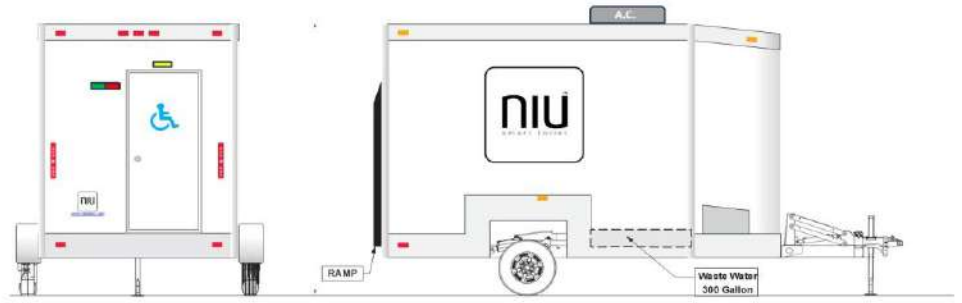
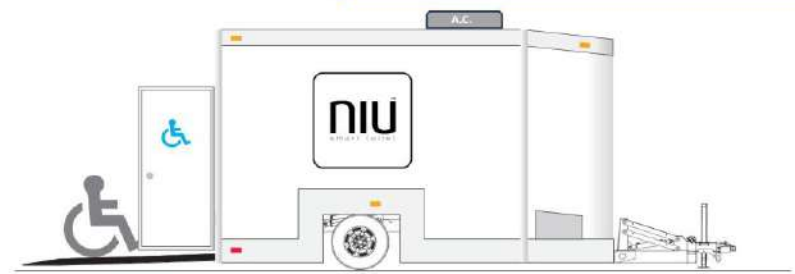

**NIU** 530 Rue Beaudet  
Longueuil, QC J4W 1M2  
Tel: 514-381-1000  
Fax: 514-381-1001  
Date: 01-23-2025

**Mobilio 4- 26 Foot 8 Station Washroom Trailer  
1 ADA + 3 Womens + 4 Mens**

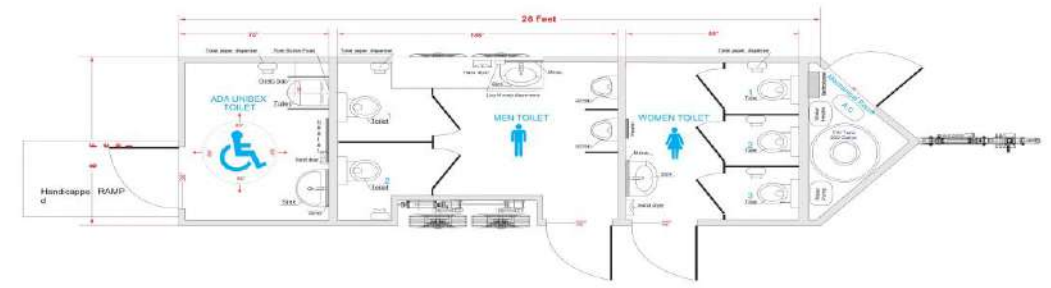
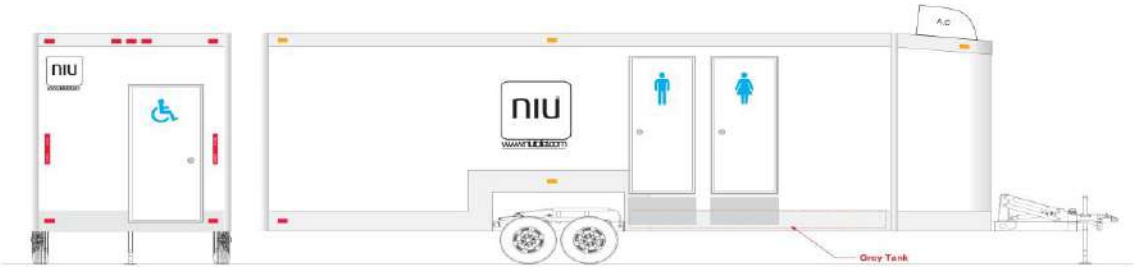
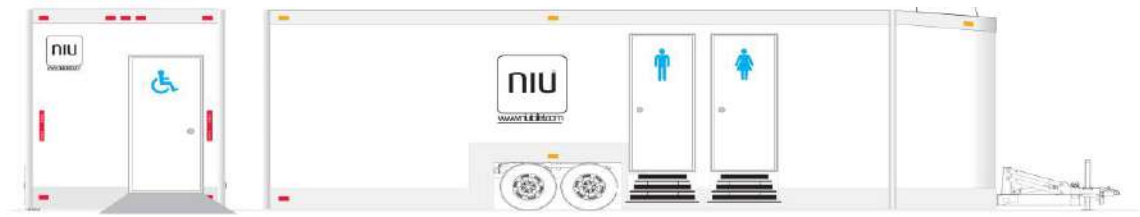

Approved by: \_\_\_\_\_  
Signature: \_\_\_\_\_

Date: / /

**NIU** 530 Rue Beaudet  
Longueuil, QC J4W 1M2  
Tel: 514-381-1000  
Fax: 514-381-1001  
Date: JANUARY 2025

# - ADA TRAILERS - EXAMPLES OF VARIOUS SHOWER/TOILET MODELS



ADA Compliant

**Mobilio 2- 16 Foot 2 Station Washroom / Shower Trailer**  
**1 ADA + 1 Universal**

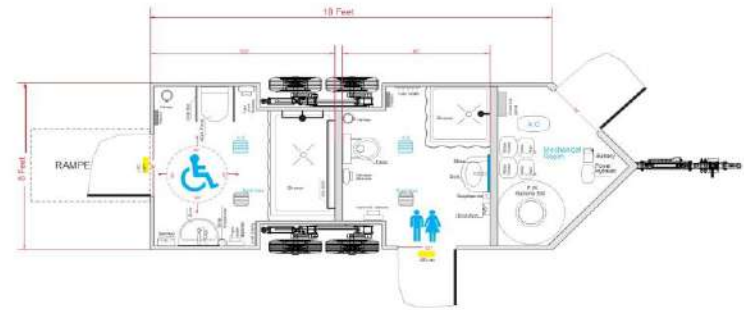
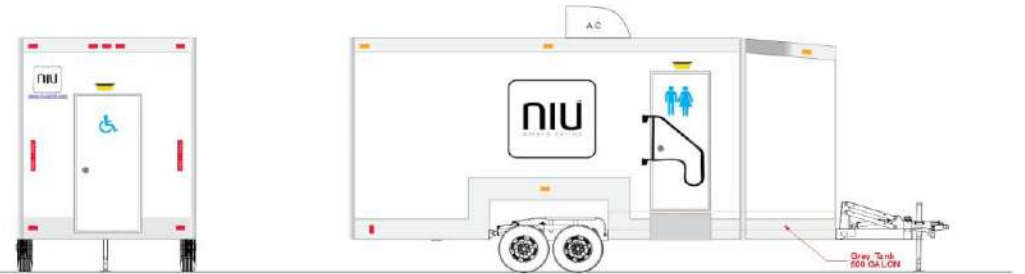

Approved by: \_\_\_\_\_  
Signature: \_\_\_\_\_

Date: / /



**Mobilio 4- 26 Foot 5 Station Washroom / Shower Trailer**  
**1 ADA + 2 Womens + 2 Mens**

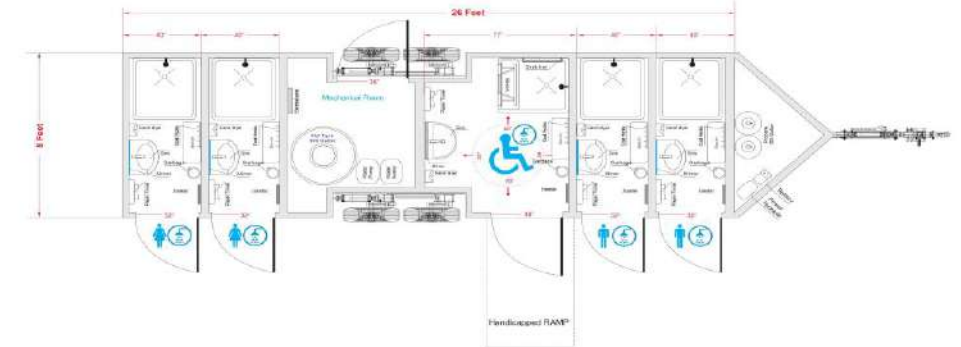
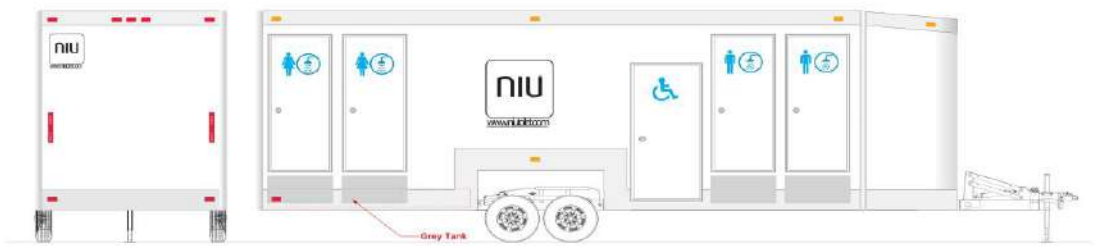
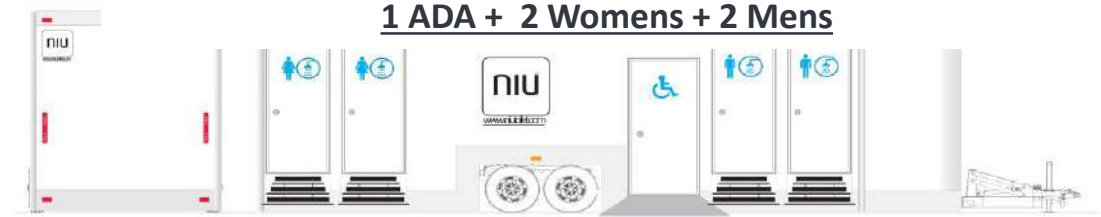

Approved by: \_\_\_\_\_  
Signature: \_\_\_\_\_

Date: / /



# Permanent Washroom Solutions- 10 FOOT-40 FEET

(all units- no matter what size- come equipped with all the product features as listed below)

## CBOX- 20-40 FOOT WASHROOM STRUCTURE



- Exterior finish (options)
- Stone
  - Steel
  - Wood
  - or other

Exterior finish colors

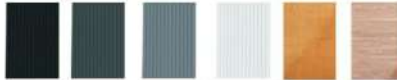

## DBOX- 10 FOOT WASHROOM STRUCTURE

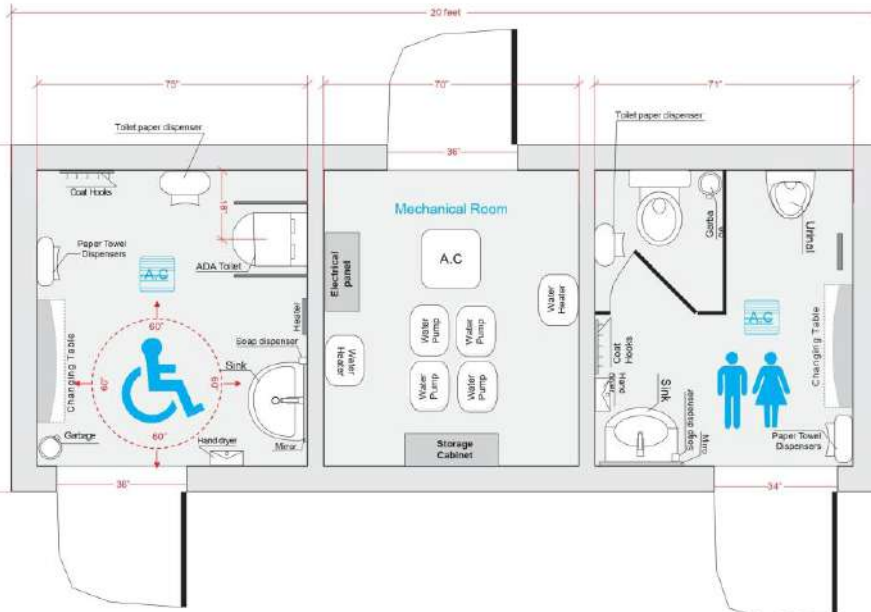

# CBOX- 20 FOOT- WASHROOM STRUCTURE

(all units- no matter what size- come equipped with all the product features as listed below)



## NIU TOILET- PERMANENT SOLUTIONS:

- > All units are custom designed as per customers needs/specs and final layout is approved prior to build
- > Units are designed for year-round use
- > Extensive Warranties on all units
- > HVAC and UNLV self cleaning and disinfection systems in all units
- > Units can be self-contained and/or directly connected to city services
- > Each unit is designed with cutting-edge technology and are furnished with all standard washroom accessories and features
- > All ADA units are fully equipped with ADA approved equipment and accessories
- > Multiple exterior finishing options available

# CBOX- 20-40 FOOT- WASHROOM/SHOWER STRUCTURES

(Some examples shown below of different layouts done)



**C-BOX- 8 X 20  
2 STATION- ADA**

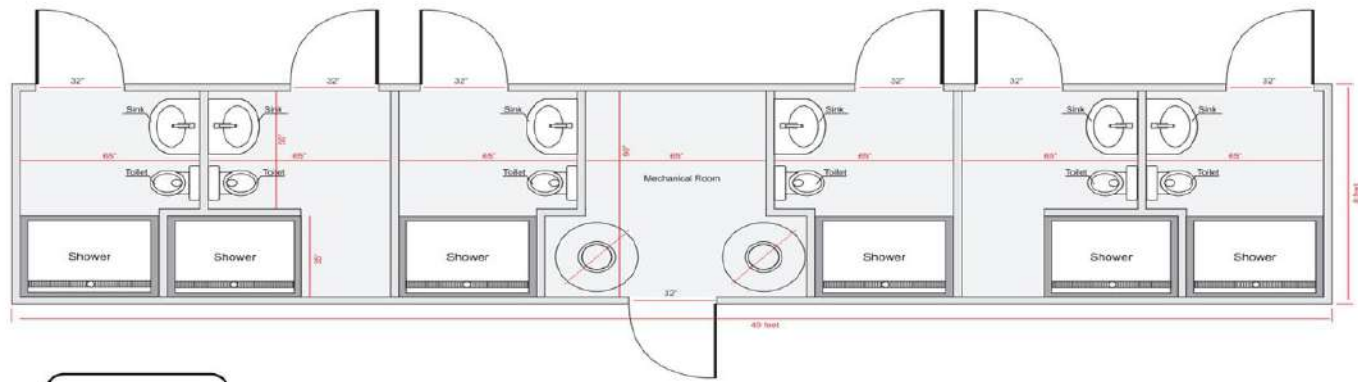

**C-BOX-40 FOOT  
6 station  
Washroom/Shower**



ADA Compliant

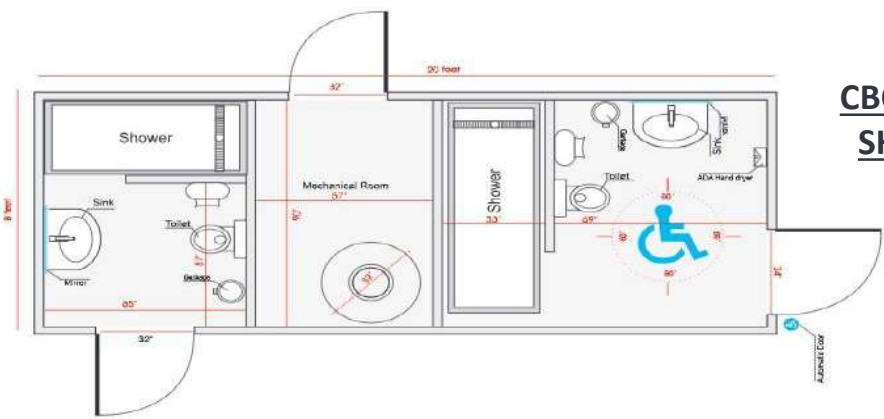
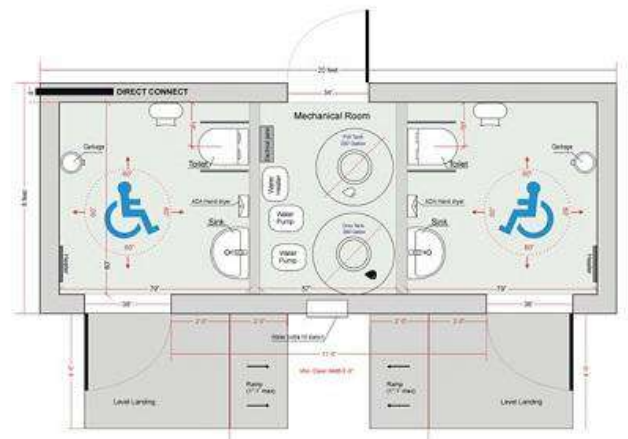

**CBOX- 20-FOOT 2 Station ADA + UNI-SHOWER WASHROOM STRUCTURE**



# Niu Trailer Models:

- Mobile Cargo Trailers
- Utility Trailers
- Kitchen Trailers
- Mobile Locker Trailers
- Mobile Office Trailers
- Mobile Rehab Trailers
- Mobile Research Trailers
- And- other custom trailers

## NOTE:

- We offer multiple configurations and options as far as layout and design for each trailer style, and model offered.



Cargo Trailers   Research Trailers   Combo Trailers   Office Trailers   Rehab Trailers

Toilet Trailers   Shower Trailers   Laundry Trailers   Locker Trailers   ADA Trailers

# NIU<sup>TM</sup>

## TRAILERS

[www.niutoilet.com](http://www.niutoilet.com)  
[info@niutoilet.com](mailto:info@niutoilet.com)

**NEW LAYOUTS NOW AVAILABLE**  
**ALL CUSTOM BUILT**



# CARGO TRAILERS- 12 FOOT-30 FOOT



## NIU TRAILER- KEY ELEMENTS:

- > All units are custom designed as per customers needs/specs and final layout is approved prior to build
- > Units are designed for year-round use
- > Extensive Warranties on all units
- > Each unit is designed with cutting-edge technology
- > Any model of trailer is available in multiple sizes and layouts



# NIU TRAILERS- EXAMPLES OF VARIOUS MODELS LAUNDRY TRAILERS / LOCKER TRAILERS



**Mobilio 5- 30 Foot LAUNDRY TRAILER**

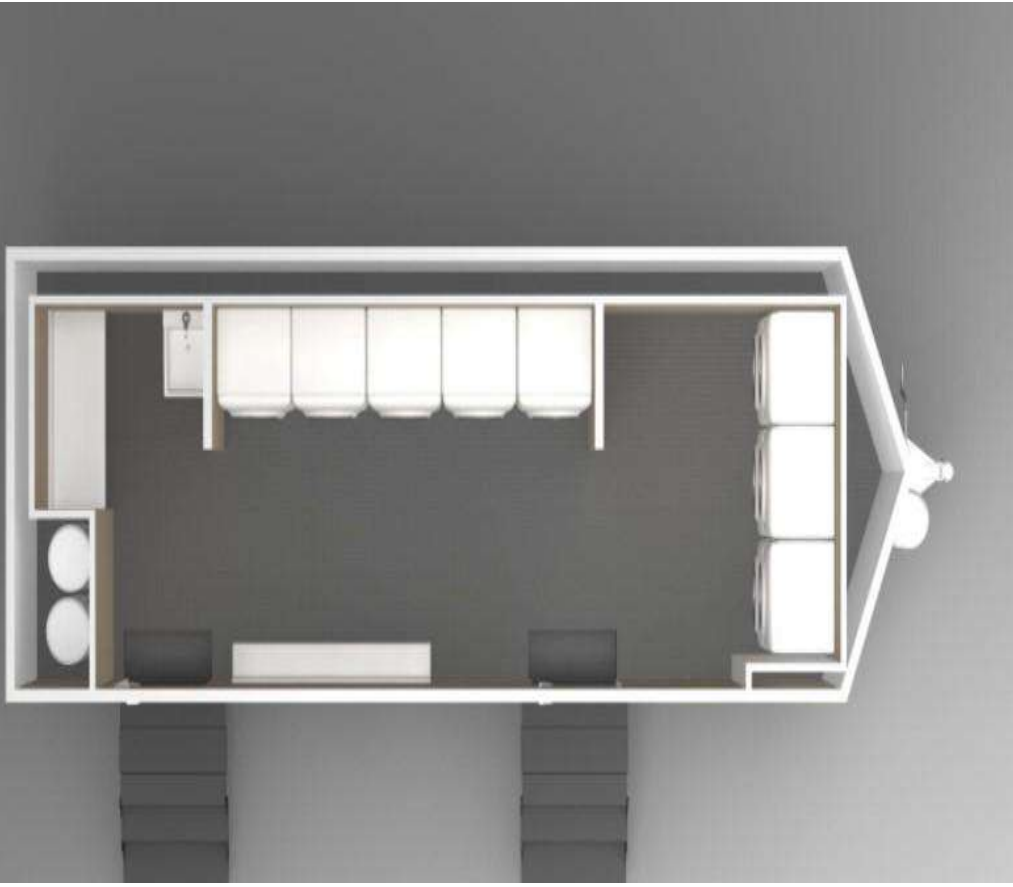

**Mobilio 8- 56 Foot LOCKER Trailer**

